

It's like having a guard in each guestroom



One eye on the future – the other on the past

We may not be able to predict the future, but with the Sentinel Advanced in-room electronic safe, it's easy to see what's in the past. Utilizing the most advanced audit trail system on the market, the hand-held SafeLink unit is capable of printing out the last 100 safe events, including who opened the safe and when. The ability to provide such valuable information on demand, and in the presence of the guest can help protect the hard-earned reputation of your property and staff, as well as reducing false liability claims. The SafeLink unit also provides a user-friendly service management tool with sophisticated password

protection that has set a new standard in the industry. In addition, the Sentinel Advanced model offers all the innovative security features included in the Sentinel series, such as a revolutionary locking mechanism, anti-tamper labyrinths, and extended solid-steel hinges. Its unique modular construction and reprogrammable software allow you to plan for the future, as well. You can even upgrade to new technologies such as Biometric access. The Sentinel Advanced is part of a proud heritage of Elsafe electronic safes, the reliable world leader in hotel safe technology for over 20 years. Now that's a past that guarantees your future satisfaction.

SENTINEL

Advanced



FEATURES

- Simple 4-digit PIN code operation
- Highly visible LED display
- Audit trail capability with hand-held SafeLink unit
- Revolutionary locking system with inter-locking deadbolt mechanism
- One piece, cold-pressed curved door is over 70% stronger than flat steel door
- Extended solid steel bolt hinges for maximum security and durability
- Solid, arc-welded heavy-gauge steel construction and recessed back for superior strength and security
- Anti-tamper, auto relock function
- Three convenient standard sizes available
- Attractive, ergonomic design
- Unique modular construction for easy upgradability

TECHNICAL INFORMATION

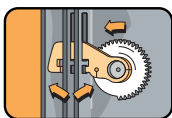

ELSAFE'S REVOLUTIONARY LOCKING SYSTEM RESISTS FORCIBLE ENTRY.

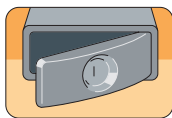

ONE-PIECE COLD-PRESSED DOOR IS OVER 70% STRONGER THAN FLAT STEEL DOOR.

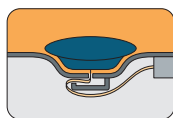

ANTI-TAMPER LABYRINTHS PROTECT SENTINEL ELECTRONICS FROM MANIPULATION.

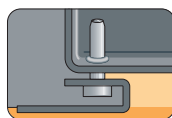

EXTENDED SOLID STEEL BOLT HINGES ARE SECURE AND ULTRA-RELIABLE.

With the state of the art security features offered in the Sentinel Series of in-room safes, there is simply no better way to protect the property of your guests at such an affordable price. Based upon the Elsafe industry-leading Infinity Collection that has been widely applauded since being introduced, the Sentinel Series is setting new standards for strength and security, while offering an economical solution that won't break your budget.

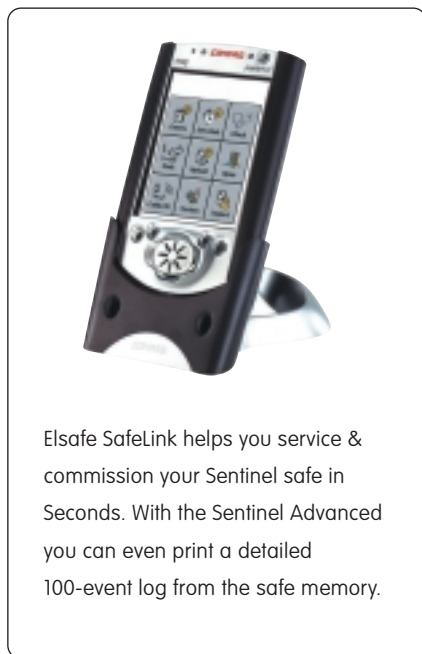

Elsafe Safelink helps you service & commission your Sentinel safe in Seconds. With the Sentinel Advanced you can even print a detailed 100-event log from the safe memory.

Sentinel Advanced		Model code SA		
Sizes		25, 41 and 49 cm external depth		
Measurements		SK25	SK41	SK49
Outside H/W/D	mm	200/432,3/250	200/432,2/412,6	200/432,2/493,4
	in	7 7/8 / 17 / 9 7/8	7 7/8 / 17 / 16 1/4	7 7/8 / 17 / 19 1/2
Inside H/W/D	mm	196/428,2/142,8	196/428,2/304,5	196/428,2/385,3
	in	7 3/4 / 160 7/8 / 5 5/8	7 3/4 / 160 7/8 / 12	7 3/4 / 160 7/8 / 15 5/32
Door opening H/W	mm	148/320	148/320	148/320
	in	5 3/4 / 12 9/16	5 3/4 / 12 9/16	5 3/4 / 12 9/16
Internal volume	litres	12	25,5	32,3
	cu ft	0,4	1	1,1
Weight	kg	10,8	13,9	15,5
	lb	23,8	30,6	34,2
Locking mechanism	Inter-locking deadbolt mechanism			
Locking/access code	4-digit			
Closing	Push button			
Inside carpet	Yes			
Display	Yes			
Beeper	No			
Override	Electronic key, Service unit Sentinel or the Safelink			
Memory function	Yes			
Power supply	5 A4-cells in keyboard			
Steel thickness	Door, frame and back-wall: 2,5 mm / Body: 2 mm			
Fastening methods	Back wall: 2 bolts / Bottom: 4 bolts			

The Sentinel series consists of three more models:



Sentinel Plus: The difference is easy to see.



Sentinel Standard: Basic digital security taken to a new level.



Sentinel SmartKey: A simple solution to superior guestroom security.